

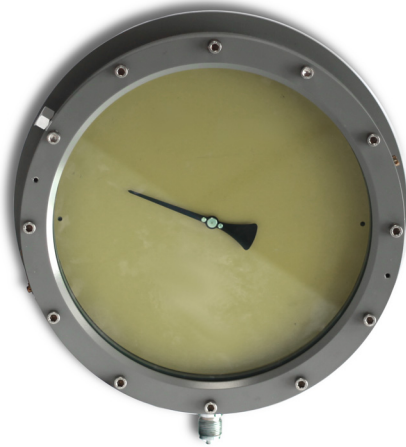







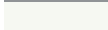

Depth Gauge - M0060



- nominal size: 250
- antimagnetic, maintenance-free
- shock and vibration resistant as per BV 043/044
- rear mounting rim
- with venting screw

Applications shipbuilding, naval shipbuilding,
Media water, sea water

Available Versions				
measuring element	bourdon tube			
process connection	G1/2"A, bottom			
accuracy class	0,6 as per DIN EN 837-1			
short term overpressure	130% of scale			
Technical Limitations				
operation temperature	min		max	
temperature influence	-20°C		+50°C	
weight	9kg		±0,4% FSO / 10K	
Material				
casing	aluminium			
wetted parts	copper alloy			
window	safety glass			
Colours				
casing	black		RAL 9005	
	grey		RAL 7037	
scale background	white		RAL 9010	
	black		RAL 9005	
scale labels	fluorescent		UVG 75 green	
	yellow		RAL 1021	
pointer	fluorescent		UVG 75 green	
	black		RAL 9005	
	black		RAL 9005	
	yellow		RAL 1021	
	fluorescent		UVG 75 green	
*other colour options on enquiry				

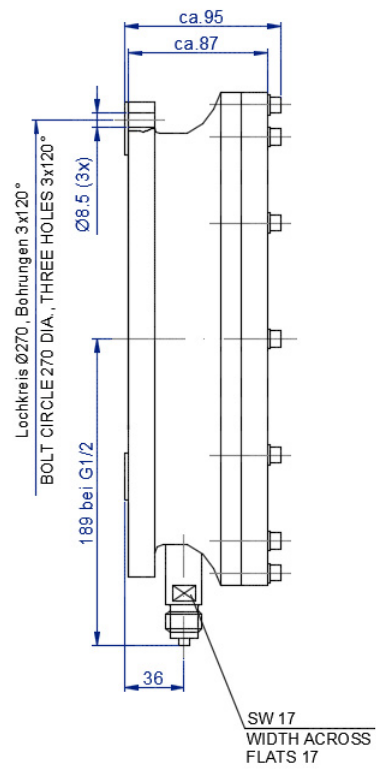
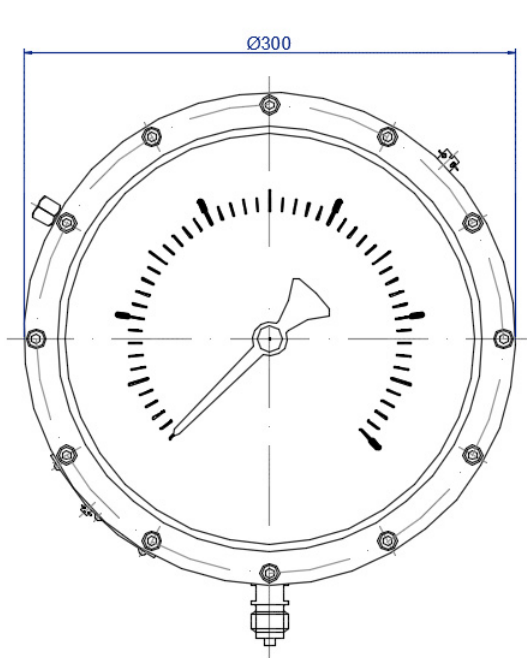
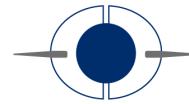

Dimensions
(mm)