

## Safety Valve M88A for LVL930

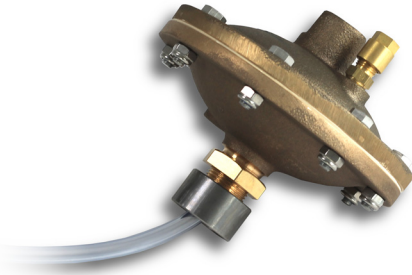

The membrane safety valve M88A prevents the measuring medium from entering the air circulation in case of leakage or failure of the air supply. As soon as the input pressure falls, the valve will close. When the pressure is back to the normal levels, the safety valve will automatically reopen.

The device has a G1/2" connection and an adjustable trottle screw in the pressure inlet connection for the use with the level sensor 930.

Connection		
process connection	G 1/2" inside	*other options on request.
connection stay pipe	DN 25	
connection pressure inlet	DN 8	
Technical Limitations		
pressure inlet	max 3 bar	
vibration proof	max 4 g (acc. to DIN EN 60068-2-6)	
Material		
casing	bronze	
pressure inlet	brass	
diaphragm	NBR	

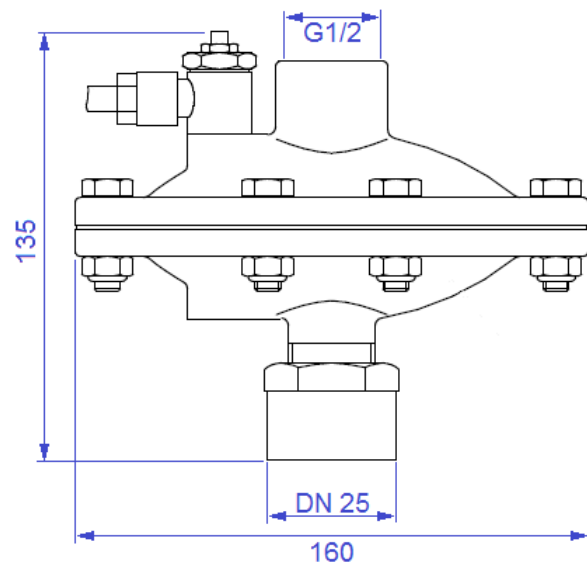

dimensions (in mm)